



a Geberit company

2100 South Clearwater Drive  
Des Plaines, IL 60018  
Phone: 847-803-5000  
Fax: 847-803-5454  
www.chicagofaucets.com

**FOR TECHNICAL ASSISTANCE**  
1-800-TEC-TRUE (1-800-832-8783)

# REPAIR PARTS

BY: SID    DATE: 10-25-11  
CHK: *[Signature]*    REV: 10-20-14

FITTING NO.
<b>927-HWCP</b>
SUBMITTED MODEL NO.
ITEM NO.

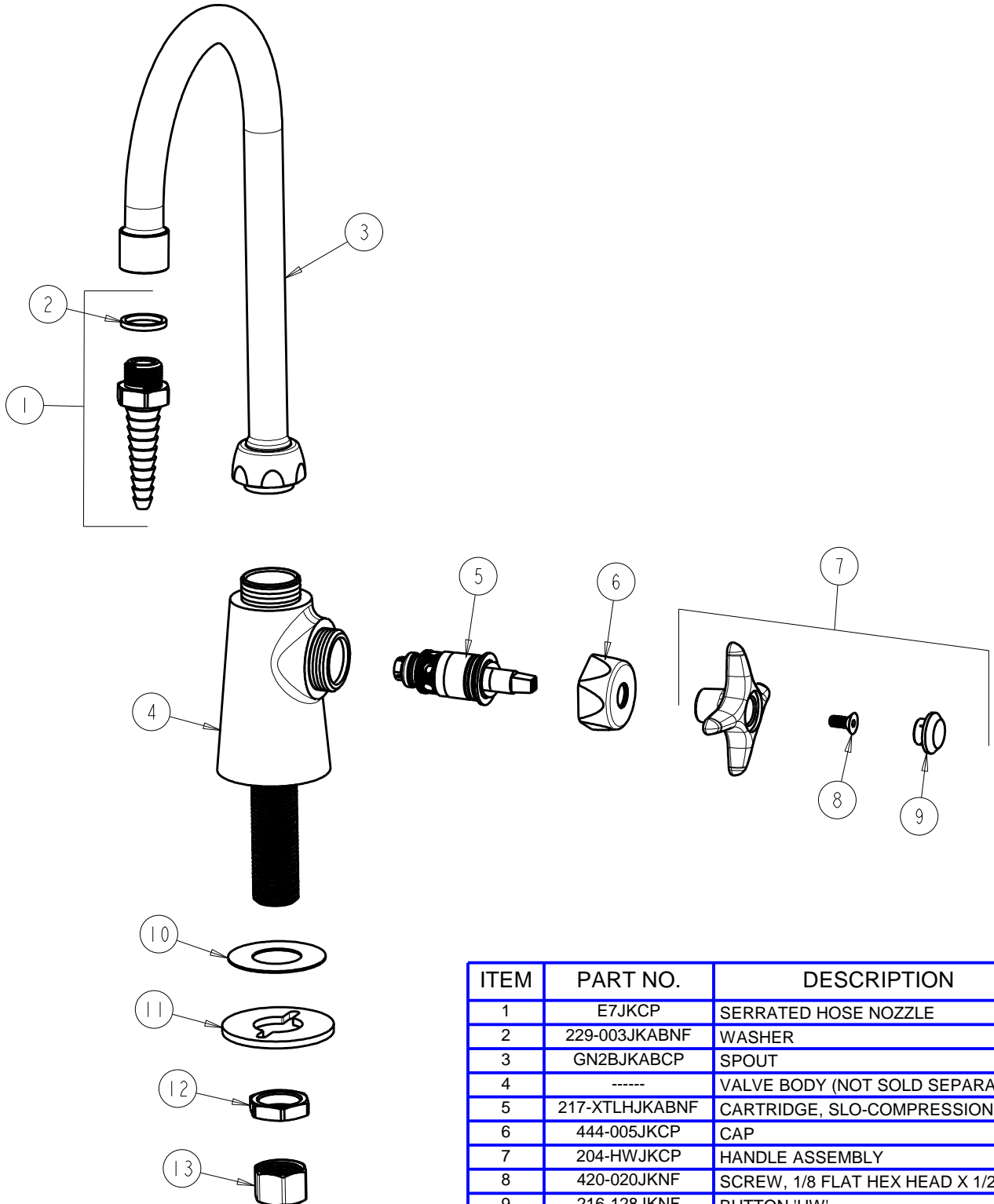

ITEM	PART NO.	DESCRIPTION
1	E7JKCP	SERRATED HOSE NOZZLE
2	229-003JKABNF	WASHER
3	GN2BJKABCP	SPOUT
4	-----	VALVE BODY (NOT SOLD SEPARATELY)
5	217-XTLHJKABNF	CARTRIDGE, SLO-COMPRESSION (LH)
6	444-005JKCP	CAP
7	204-HWJKCP	HANDLE ASSEMBLY
8	420-020JKNF	SCREW, 1/8 FLAT HEX HEAD X 1/2
9	216-128JKNF	BUTTON 'HW'
10	333-103JKNF	RUBBER WASHER
11	807-112JKNF	WASHER
12	49-004JKRBF	LOCKNUT
13	49-005JKRBF	COUPLING NUT